

Broschürenfertiger
Booklet Maker
Agrafeuse-plieuse
Plegadora grapadora
Bookletmaker
Urządzenie do broszurowania

DE Betriebsanleitung
EN Operating Instructions
FR Mode d'emploi
ES Instrucciones de uso
NL Gebruiksaanwijzing
PL Instrukcja obsługi

IDEAL 8590



EN Operating Instructions (23 – 43)

Definition of normal use	24
Safety instructions	24
Product features	26
Included in the box	27
Overview and description of parts	28
Control panel	29
Startup	31
Making booklets	32
Adjusting the paper stop	34
Refilling staples	35
Adjusting the stapling heads	36
Care and maintenance	37
Troubleshooting	38
Technical data	39
Terms of warranty	40



Introduction

Thank you for choosing a device from IDEAL.

Definition of normal use

- The IDEAL 8590 is a tabletop bookletmaker.
- Please read these operating instructions before starting to use the device and please follow the safety instructions.
The operating instructions must be kept available with the device at all times.



Safety instructions

- Keep packing material, such as plastic wrapping, away from children! (Risk of suffocation)
- Please follow the safety instructions to avoid fire or electric shock.
Only use the device indoors.
- Only use a wall socket that supplies the correct voltage (see rating plate)
- Do not modify or repair the device.
- Do not use the device if the power cable or mains plug is damaged or if the connection at the wall socket is not stable.
- Make sure that the power cable is not crushed while you are using the device and that it cannot be damaged in any other way. Place the cable so that no one will trip over it. Do not place the power cable under strain, i.e. do not pull it tight.
- Disconnect the plug from the wall socket for cleaning and whenever the device is not in use for a significant period of time.
- Do not touch the plug or the device if you have wet hands.
- Do not use volatile liquids, petroleum, paint thinner or polishing paste to clean the device. Such liquids may damage the surfaces of the device.
- Do not install or store the product in an unstable area or an area exposed to vibrations from other equipment.
- Use both hands to lift or move the product and hold the product from the back.
- Do not attach anything to the device and do not place heavy objects on top.
- When loading sheets of paper, do not exceed the specified maximum number of sheets.
- Do not use thick, torn or old paper.
- Do not use force to push in the paper.



Safety instructions

- Children may not recognise hazards associated with electrical equipment. You should therefore always supervise children near and around the bookletmaker.
- Anyone who is not familiar with the operating instructions, any children and anyone under the influence of medication, alcohol or drugs must not use the device or may only use it under supervision.



Danger

Risk of injury from electric shock.
Always disconnect the plug before

- Maintenance and cleaning
- Moving the machine



Danger

- Do not use any spray cans with flammable content near to the booklet maker!



Danger

- Do not use any flammable cleaning agents.

Product features

- Easy and intuitive to operate with membrane keyboard, self-explanatory symbols and integrated LED counter.
- The IDEAL 8590 bookletmaker folds and staples automatically in a single process.
- Patent pending for staple mechanism with conventional stapling and space-saving flat stapling.
- Can produce booklets of up to 64 pages (paper: 80 g/m²)
- The stapling heads can be repositioned tool-free.
- Staples can be refilled quickly and easily.

Included in the box

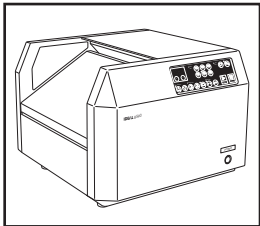

IDEAL 8590

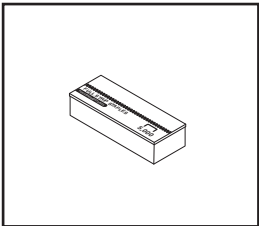

**1 box of staples
(5000 staples)**

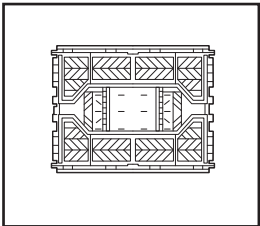

**Foldaway
collection box**

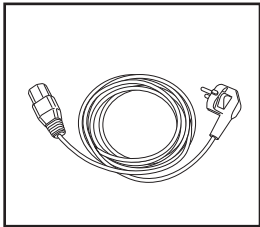

Power cable



**Printed operating
instructions**

Overview and description of parts

Front

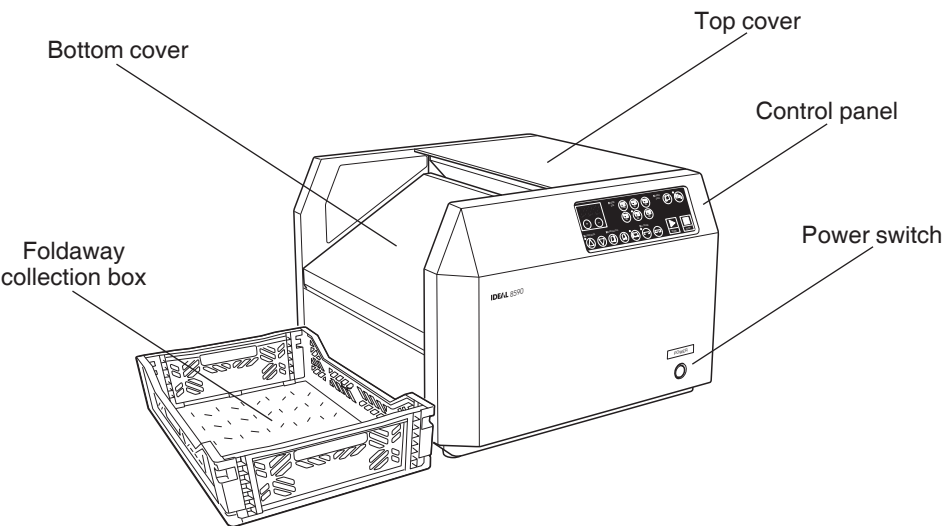

Back

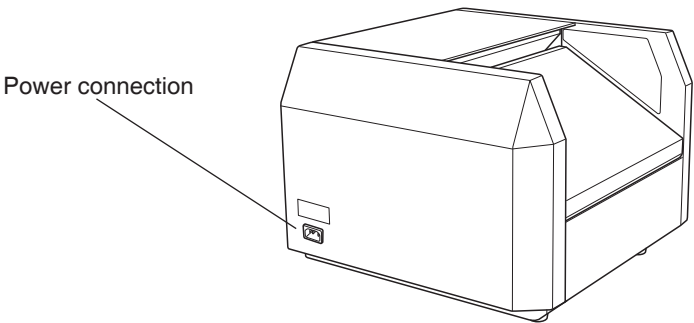

Control panel

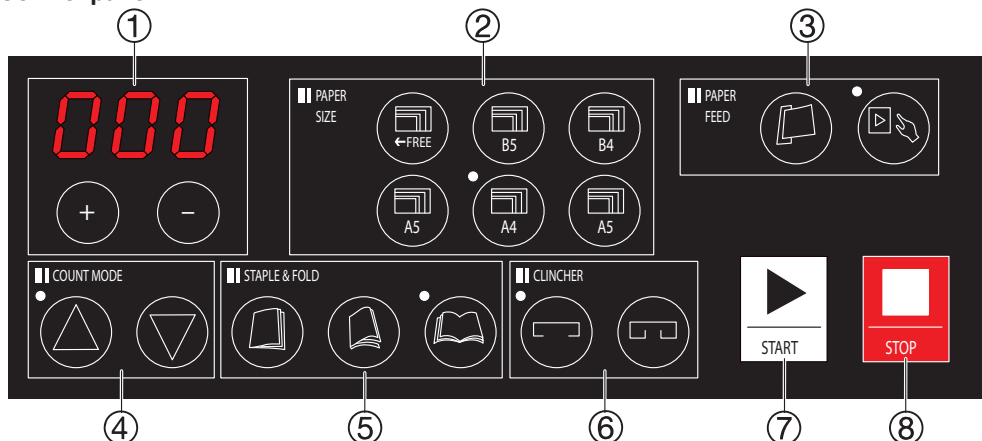

① Counter

- In "Total counter" mode (△), the counter displays the number of booklets the device has counted. In "Preset counter" mode (▽), the counter subtracts the number of booklets that have been counted from a preset value and displays the remaining number.
- When you change the paper size (by pressing the paper size on the control panel, e.g. A4 , twice), the counter displays the change for 4 seconds, which can be finely adjusted within a range of +/- 5 mm. If the paper size is set to "FREE" (size can be freely selected), the counter displays the full length for 4 seconds.
- In side binding mode (⌋) (press twice), the counter displays the setting for 4 seconds, which can be adjusted within a range of 8-15 mm.
- In "Automatic mode" (⌋) (press twice), the counter displays the detection time for 4 seconds, which can be adjusted within a range of 1-5 seconds.
- The above values can be increased or decreased by pressing the plus (+) and minus (-) buttons.

② Paper size

- Select the original paper size from the following options: B5, B4, A5, A4, A3 and FREE.
- If you select FREE, you must set an original paper size within a range of 110-484 mm.
- Press one of the buttons twice. While the indicator is flashing, you can adjust the paper size with the plus (+) and minus (-) buttons (fine adjustment to +/- 5 mm for all preset paper sizes).

③ Paper feed

- Automatic mode: Press the "Auto" button. The device starts up automatically when the optical sensor detects that paper is being fed. Press the "Auto" button twice to change the detection time (1-5 seconds). Use the plus (+) and minus (-) buttons to change the time.
- Manual mode : The device only starts when the "Start" button is pressed.

Control panel

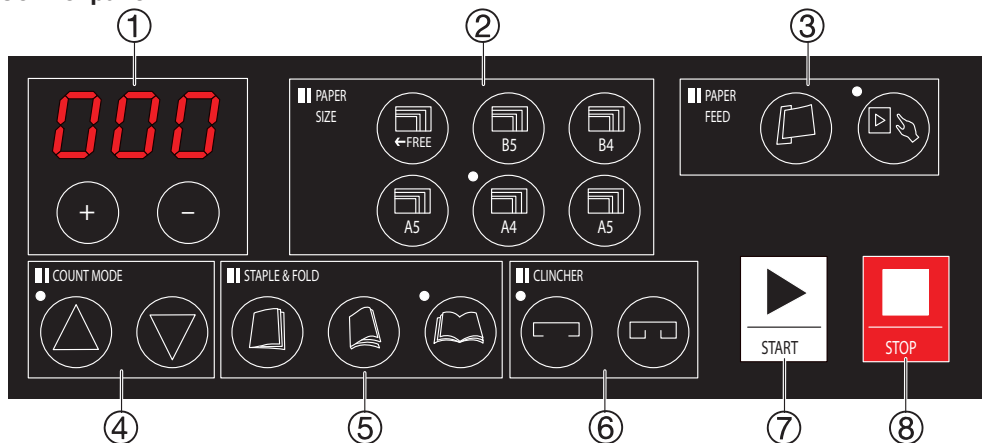

④ Counter mode

- Press the button for Total counter mode or the button for Preset counter mode. In Preset counter mode, you must define a preset value. Use the plus and minus buttons to adjust the preset value.
- Values that are longer than three digits cannot be displayed or set.

⑤ Staple & fold

- If side stapling is selected, the device staples at the side of the paper. Press the button for side stapling twice to adjust the stapling position within a range of 8-15 mm. Use the plus and minus buttons to adjust the position value.
- If centre stapling is selected, the device staples in the centre of the paper.
- If folding is selected, the device folds without stapling (fold only).

⑥ Clincher

- Press the button to press the ends of the staples flat (flat stapling).

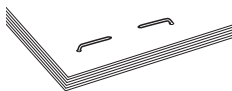

- Press the button to bend over the ends of the staples flat (conventional stapling).

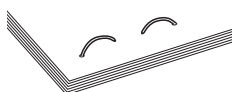

⑦ Start ⑧ Stop

- Press the start button to start the binding process. Press the stop button to stop the binding process.

Startup

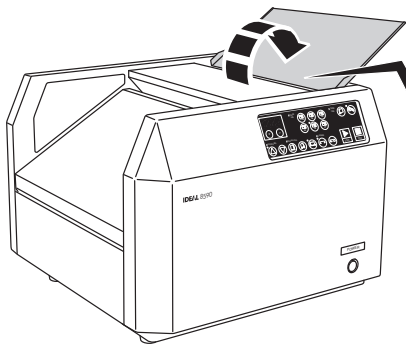

Open the top cover.
This cover has a scale for setting
the paper format.

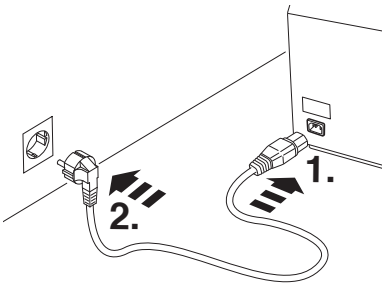

Connect the power cable to the device first,
then to the socket.

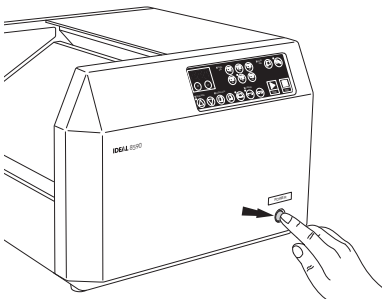

Switch on the device using the power switch.
The counter starts to flash, then is lit
continuously after a few seconds. The device is
ready for use.

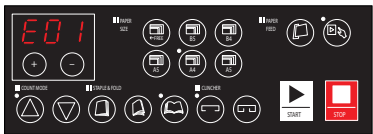

The counter may also display one
of 3 messages:

- | | |
|-------------------------|----------|
| E1: Cover open | → Close |
| E2: Staples empty | → Refill |
| E3: Paper in paper tray | → Remove |

Making booklets

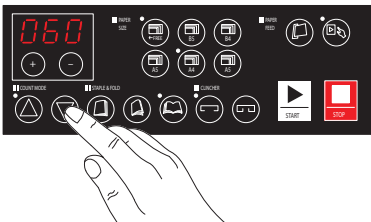
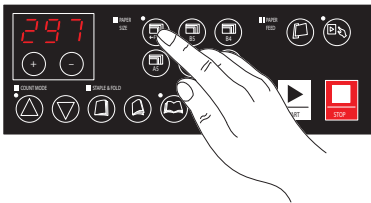
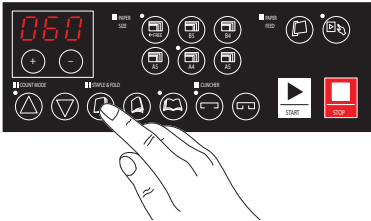
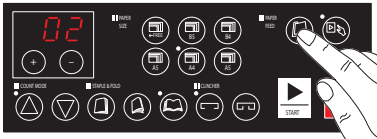

1. Choose between automatic and manual paper feed mode.

2. Select stapling method:

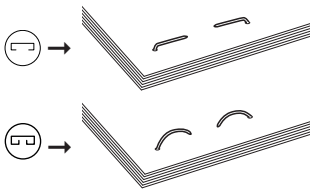

3. Select staple, fold or staple and fold.

4. Select paper size: FREE, B5, B4, A5, A4 or A3.

5. Select Total or Preset counter.

Making booklets

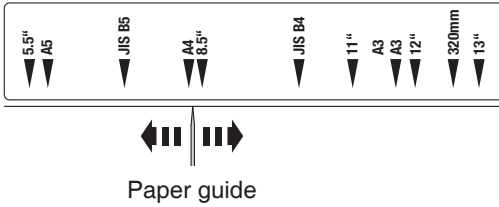

6. Set the paper format (paper guide) to your sheet size.

7. Place the sheets in the paper tray.
The sheets should held in place, but not too tight in the paper guides. If you have selected automatic mode (⏻), the device starts automatically.
In manual mode (⏻), press the start button .

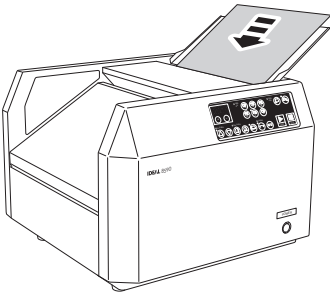

Adjusting the paper stop

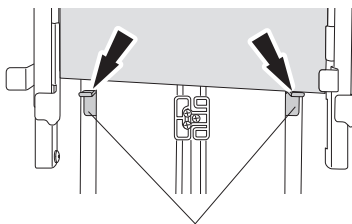
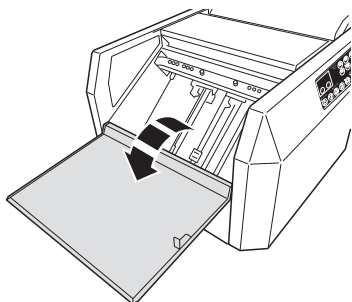

Paper stop

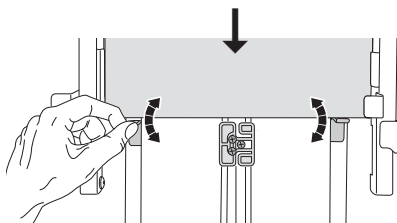
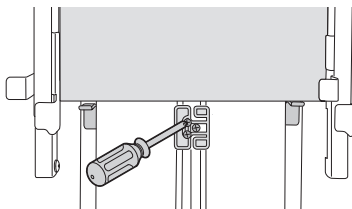

1. Switch off the device at the power switch. Disconnect the mains plug. Open the bottom cover.
2. Place a sheet of paper in the paper tray. Set the paper format (paper guide) to your sheet size. Check the end of the sheet against the stop.
3. Loosen the 3 screws in the middle of the paper stop and position the stop to the end of the paper. Tighten the screws again. Remove the paper and close the bottom cover.

Refilling staples

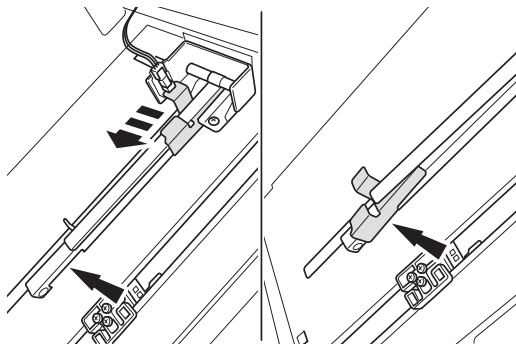

1. Switch off the device at the power switch. Disconnect the mains plug. Open the bottom cover. Pull the staple holder down and hook it into the applicable recess.

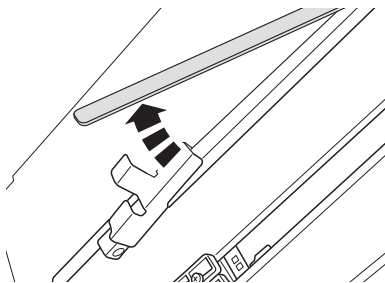

2. Open the magazine.

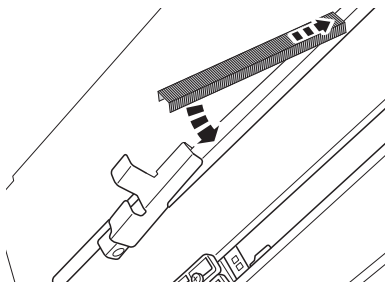

3. Insert the new staples.
Only use a new set of staples that is at least 5 cm long to refill the magazine. The system may jam if a set of staples shorter than 5 cm is used or if you attempt to use several sets of staples.

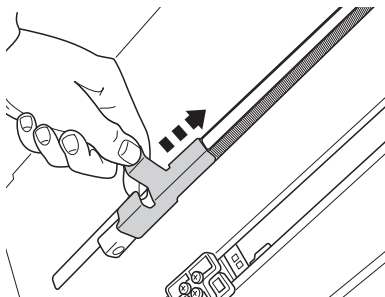

4. Bring the staple holder slowly back to its initial position.
Close the bottom cover.
Connect the power cable and switch the device back on at the power switch.

Adjusting the stapling heads

The device has two stapling heads that can be attached at spacings of 90, 135 and 180 mm. Switch off the device at the power switch. Disconnect the mains plug. Open the bottom cover. Attach the stapling heads (secured with a wing bolt) at the positions you require:

90 mm

135 mm

180 mm

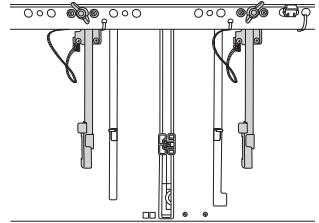
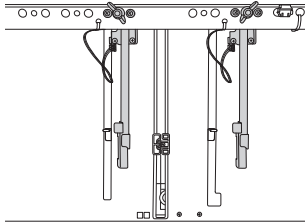
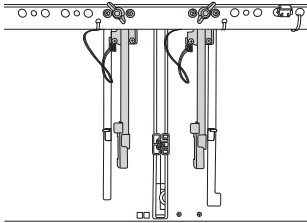

For corner stapling, you have to remove the head that will not be used:

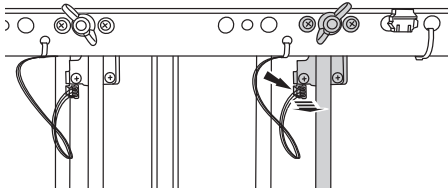

To do this, start by disconnecting the sensor plug from the stapling head.

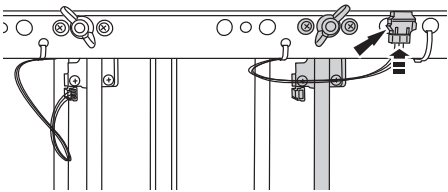

Insert the sensor plug into the dummy socket for storage.

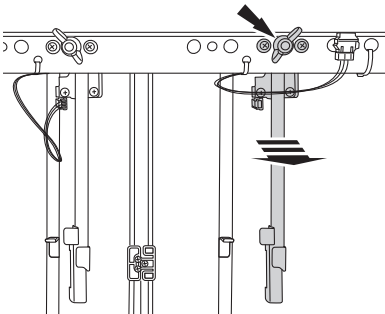

Unscrew the wing bolt and remove the stapling head.

Care and maintenance

Cleaning the optical sensor

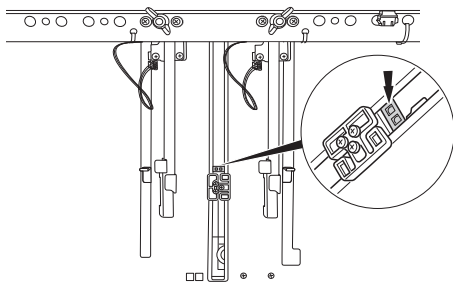

- Clean the optical sensor every day to ensure that the device functions reliably.
- Switch off the device at the power switch. Disconnect the mains plug. Open the bottom cover. Clean the optical sensor in the centre of the paper stop with an ordinary paintbrush.

1. External cleaning

- Clean the housing and the control panel with a lint-free cloth moistened with soapy water.
- Do not use volatile liquids, petroleum, paint thinner or polishing paste to clean the device. Such liquids may damage the surfaces of the device.

2. Internal cleaning

- Please contact us if you would like to clean the inside of the device. Never disassemble the device yourself, as you may cause the device to stop functioning or you may get an electric shock.

3. Wipe the rubber on the folding rollers. (**Universal-cleaning agent order no. 9000 632 or universal-cleaning tissue order no. 9000 633**)

4. Maintenance

- Please contact your dealer to arrange regular maintenance of your device.

Troubleshooting

Problem	Cause	Action
The device cannot be switched on.	Is the power cable connected correctly?	Switch off the power switch and insert the mains plug securely into the socket. Check that the power connection on the back of device is not loose.
	Are you using the right power cable?	Use the power cable supplied with the device.
The product is not working correctly.	Is the optical sensor dirty?	Clean the optical sensor (page 37).
	Is the paper being fed correctly?	Adjust the paper guides correctly so that they match the width of the paper. Make sure that the number of sheets of paper you have added does not exceed the maximum number of sheets.
	Are the staples being stapled correctly?	Use the staples that we recommend.
	Have too many sheets been added?	Do not exceed the maximum number of sheets when you add paper.
	Is the folding position correct?	Switch the power switch off and on again to move the paper stop to the start position.
E01 is displayed on the control panel.	Is the bottom cover open?	Close the bottom cover.
E02 is displayed on the control panel.	Are there enough staples in the magazine?	Follow the steps to refill staples (page 35).
E03 is displayed on the control panel.	There is probably paper left in the paper tray.	Remove the paper.

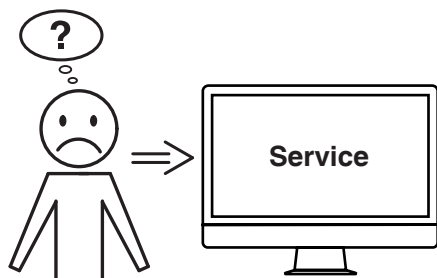

Did none of the specified solutions help you with your problem?

- Contact: Service
- www.krug-priester.com
 - service@krug-priester.com

IDEAL 8590 technical data

Power supply	220-240V 50Hz / 100-120V 60Hz
Dimensions (W x H x D)	490 x 355 x 474 mm
Weight	20 kg

Operating environment

For use in	Indoor environment
Max. recommended altitude	Max. 2000 m above sea level
Operating temperature	0 to 50 °C
Operating humidity	20% to 90% RH

Specifications for producing booklets

Paper size	330.2 x 468.0 mm ~ 110.0 x 210.0 mm
Max. number of sheets	16 sheets (80 g/m ²)
Number of stapling heads	2
Paper quality	64 to 300 g/m ²
Counter	for addition (Total counter) or subtraction (Preset counter)
Width between adjustable staples	90mm, 135 mm or 180 mm
Type of staple	Staples with order No. 9000 857
Functions	Staple and fold, fold only or staple only
Stapling methods	Conventional stapling and space-saving flat stapling
Speed	up to 800 booklets/hour
Messages on the control panel	Staple magazine empty, paper jam, cover open
Operating modes	Manual and automatic

Subject to technical changes.

Terms of warranty

IDEAL provides a warranty for this device from the date of purchase.

The terms of warranty are defined by our local representative.

- If a material or design defect occurs during the warranty period, IDEAL shall repair or replace the device, or repay the purchase price, at its discretion.
- The warranty will only be honoured if sufficient evidence is submitted, e.g. sales receipt, and the claim under warranty is made within the warranty period.
- The warranty does not cover wearing parts or parts that need to be replaced regularly.
- The warranty shall be void if the device is not set up, adjusted and cleaned/maintained correctly (in accordance with the operating instructions).
- The warranty shall be void if the device is connected to a power supply that does not comply with the rating plate data.

Storage

We recommend storing the bookletmaker in its original packing in a cool, dry place.

Disposal

Pass the outdated Booklet maker onto your specialized retailer for professional disposal.

You can find out about further disposal possibilities from your municipality.

Spare parts and accessories

You can purchase spare parts from specialized retailers. Only original parts from the manufacturer can be used.

Repairs

All further repairs may only be carried out from professionals or the service department.

This also applies to a faulty power cord. Through improper repairs, considerable danger for the operator can result and warranty claims lapse.



Recycling

Please remember to respect the local regulations: hand in the non-working electrical equipments to an appropriate waste disposal centre. The packaging material is recyclable. Dispose of the packaging in an environmentally friendly manner and make it available for the recyclable material collection-service.

Thank you!



The company Krug + Priester has the following certifications:

- Quality management system according to DIN EN ISO 9001:2015
- Environmental management system according to DIN EN ISO 14001:2015
- Energy management system according to DIN EN ISO 50001:2011





The unit is CE compliant and adheres to the following guidelines:

- 2014/35/EU for electric safety
- 2014/30/EU for electromagnetic compatibility
- 2011/65/EU, 2015/863/EU RoHS directive

The exact technical specifications can be found on the technical specifications sticker on the machine.

To claim under guarantee, the machine must still carry its original identification label.

Subject to alterations without notice.

EC-declaration of conformity

- Herewith we declare that

IDEAL 8590 Made in Vietnam

- complies with the following provisions applying to it

2014/35/EU

Low voltage directive

2014/30/EU

EMV Electromagnetic compatibility directive

2011/65/EU, 2015/863/EU

RoHS directive

- Applied harmonised standards in particular

EN 60950-1:2006/A11:2009, A1:2010, A12:2011+A2:2013

EN 61000-6-3:2007+A1:2011

EN 61000-6-1:2007

29.01.2020

Authorized representative for technical documentation:



- Geschäftsführer -

Krug & Priester GmbH & Co. KG
Simon-Schweitzer-Str. 34
D-72336 Balingen (Germany)