

# iX-5 Series Base Quick Installation Guide

For more help with your installation, please visit: [kb.quadient.co.uk/ix5\\_install](http://kb.quadient.co.uk/ix5_install)

## Machine components:

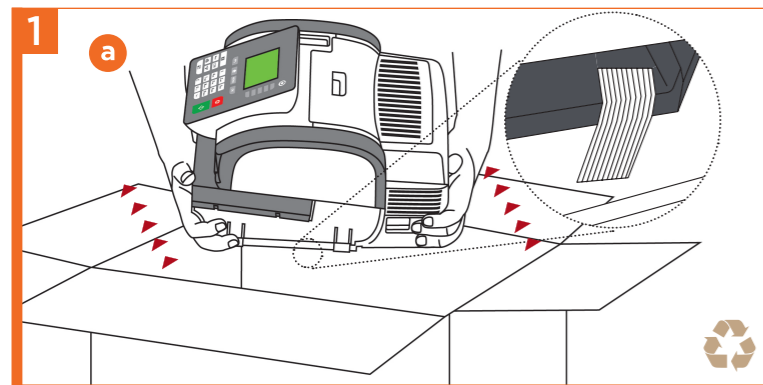
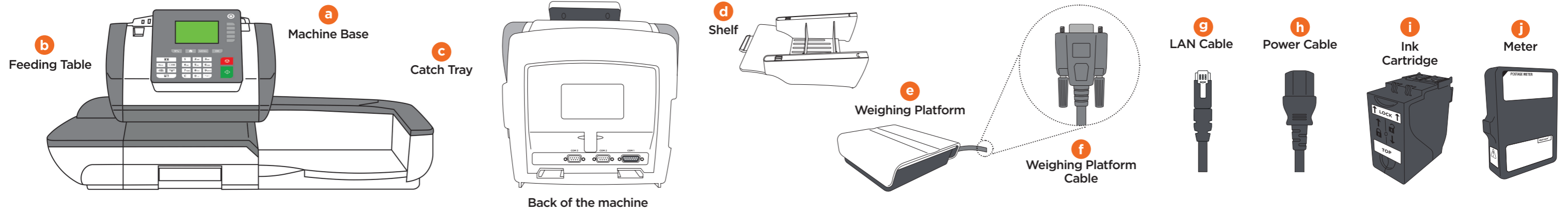

Unpack all components from the box, remove packaging and any transit tape.

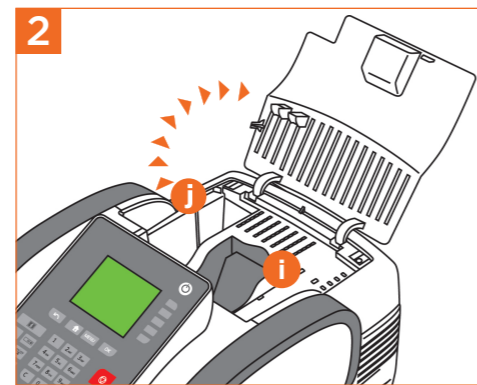

Lift the cover of the machine to reveal the ink cartridge (i) and meter (j) locations.

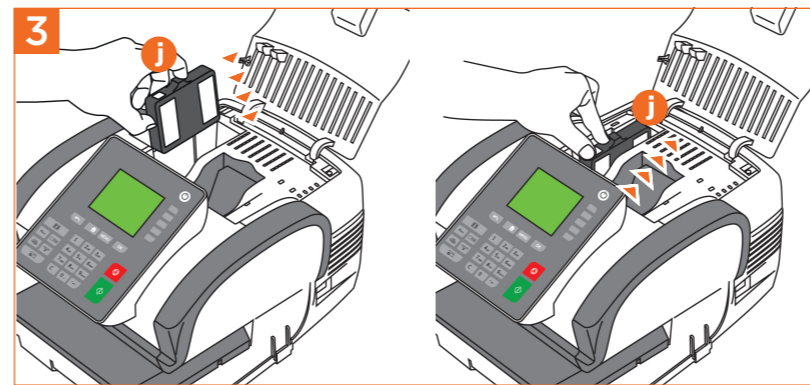

Place the meter (j) into the meter bay and slide in until it fits securely into position.

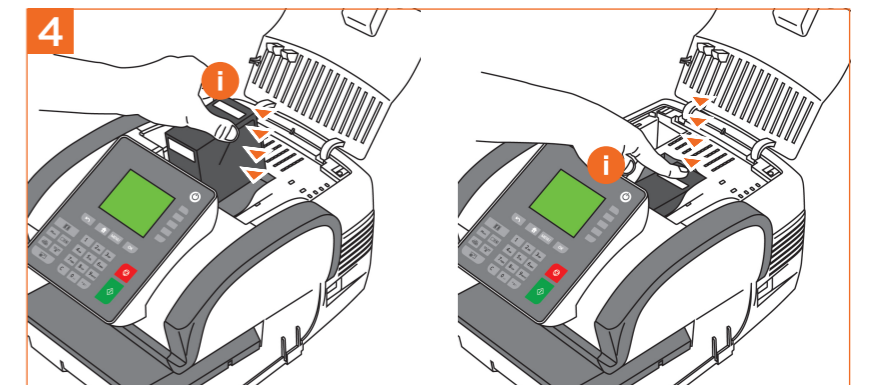

Insert the ink cartridge (i) at an angle into the machine with the 'TOP' and 'LOCK' stickers facing upwards. Push the ink cartridge (i) towards the back of the machine until you hear a 'click' - close the cover of the machine.

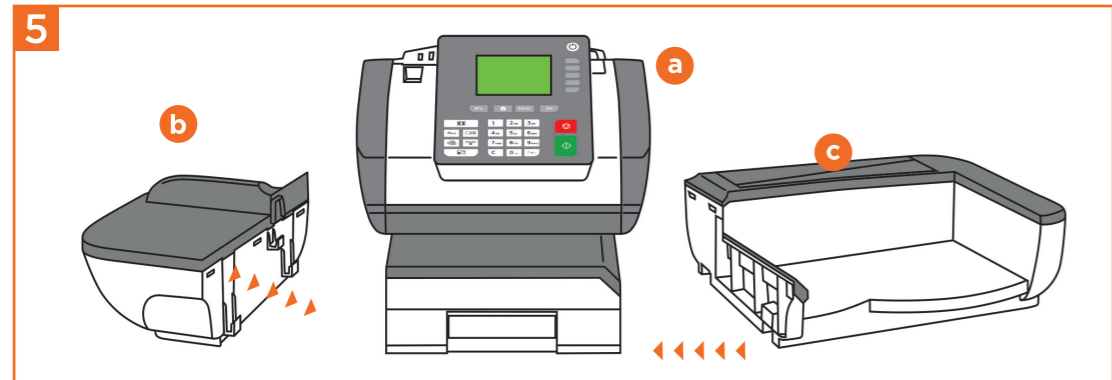

Lift machine slightly on the left hand side and align the hooks to attach the feeding table (b) - attach the catch tray (c) to the right hand side of the machine.

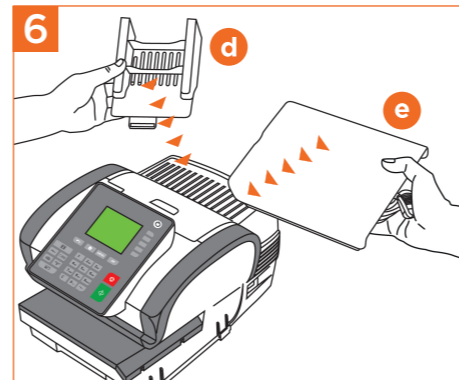

Attach the weighing platform (e) and shelf (if applicable) (d).

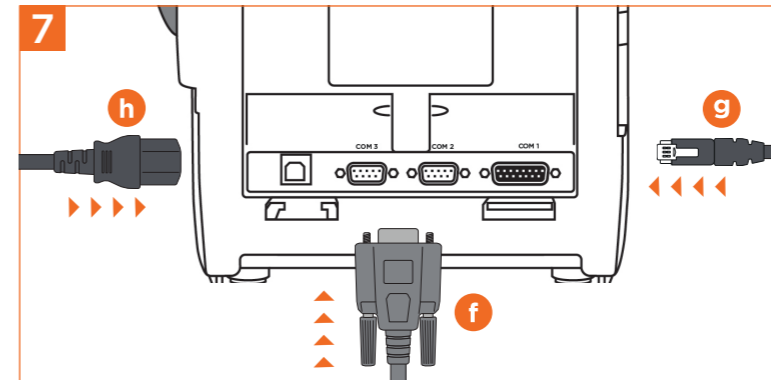

Connect the weighing platform connector (f) into a COM PORT at the back of the machine. Then connect the LAN cable (g) and power cable (h) to either side of the machine.

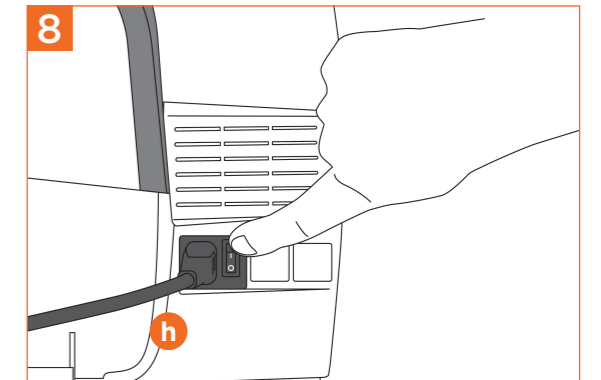

Turn on the machine using the switch behind the power cable (h) and follow the steps on screen.

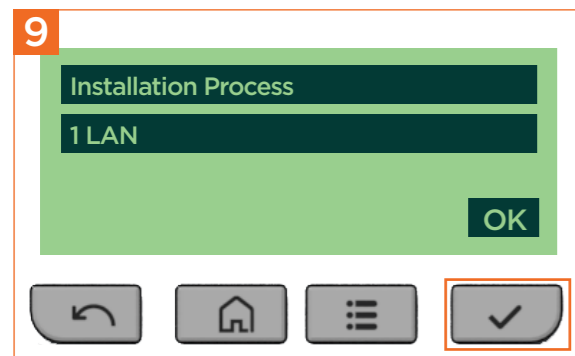

Select LAN and press  to test connection type.



Obtain registration PIN from MyQuadient.

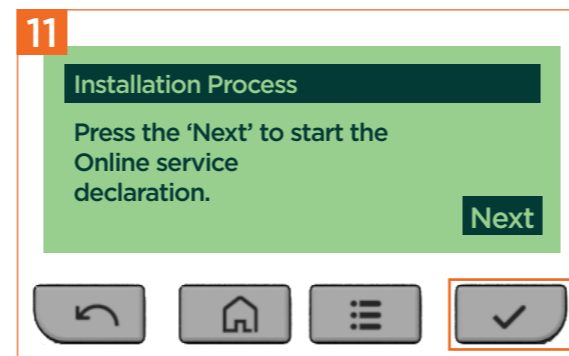

Follow the steps on screen to complete the procedure.

For more information or if you experience any issues, please visit : [kb.quadient.co.uk/ix5](http://kb.quadient.co.uk/ix5)

# IX-5 Series Quick Start Guide

## Getting to know your franking machine

### Screen Information

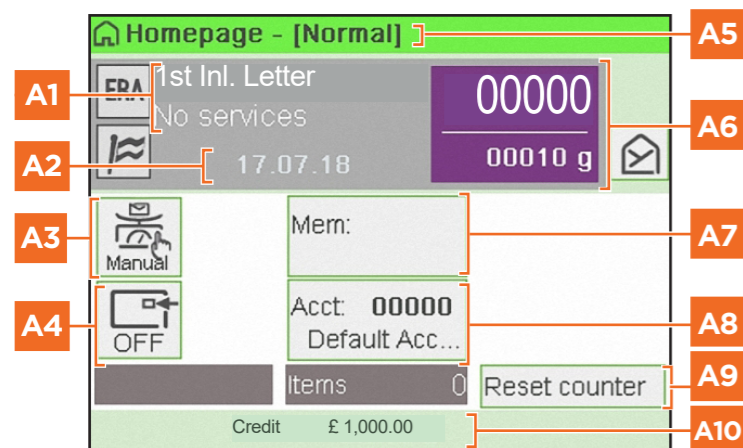

- A1 Rate and services (to change: B1)
- A2 Date printed (to change: B6)
- A3 Weighing Type (to change: B5)
- A4 Imprint position offset
- A5 Type of imprint (to change: B6)
- A6 Postage and weight
- A7 Job Memory (can contain rate, imprint settings and account)
- A8 Current account
- A9 Reset counter : to perform this action, press the button on the right side of the machine (N5)
- A10 Credit

### Shortcut keys

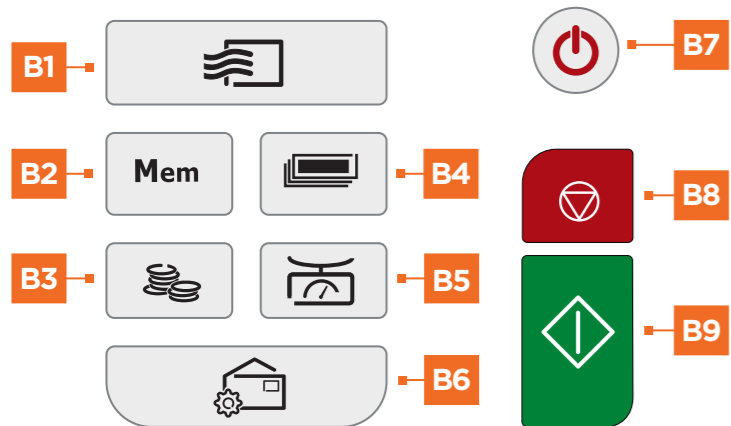

- B1 Rates and Services selection
- B2 Job Memory (rate, settings and account)
- B3 Credit management
- B4 Label printing
- B5 Weighing modes
- B6 Type of imprint and Imprint settings
- B7 Sleep/wake (amber/green)
- B8 Stops printing
- B9 Starts printing

## Quick steps to franking your mail

### 1 To reset the machine...

Press:

- to clear the information on screen.
- to wake the machine up with default settings.
- to return to the home screen.

### 2 Select a rate (and services) :

Currently selected rate and services are indicated at the top of the screen.



#### Change/add services:

1. Press . The Rate selection screen is displayed.

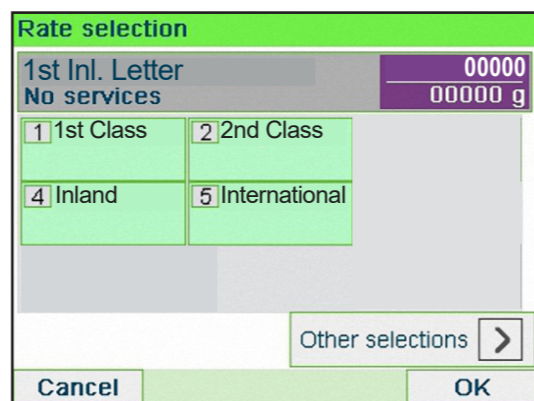

2. Use the keypad to choose a rate or service option, or use the wizard for access to more rates.
3. When done, press to confirm your selection and return to the home screen.

To order consumables for your machine please call your dealer or visit [www.quadient.co.uk](http://www.quadient.co.uk)

For more information about your franking machine and to access a range of support and features, log into your personalised account at [www.myquadient.co.uk](http://www.myquadient.co.uk) or register today.

### 3 To weigh an item:

1. Check that the A3 icon is .
2. Otherwise press and select the option: **Standard weighing**

### 4 When all steps are completed print the imprint:

If you want to print on a label or automatically seal the envelope, check additional options below.

1. Press to start the motors of your franking machine.
  2. When the rollers start, insert the mail into the machine from the left hand side.
1. Insert labels into the dispenser until a click, printing side facing the right.
  2. Press to enter the number of labels to print and then press .

#### To seal the envelopes

1. To seal the envelopes (if applicable) Use the button at the front of the sealer. Check water level in the bottle.

### Changing the ink cartridge

1. On the new ink cartridge, remove the protective strips from the printing heads.
2. Lift machine cover and follow instructions printed on sticker inside.



## If Jamming occurs

1. Press on the keypad to stop the motor.
2. Under the base, lift up the release handle and use your other hand to remove the jammed envelope.

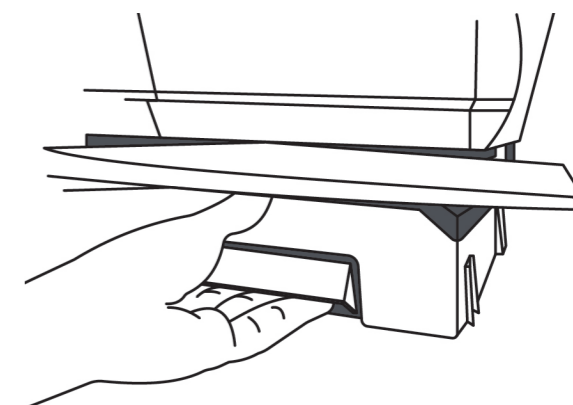

## Adding credit

Press choose 'Credit' and follow the instructions on screen.

**Note:** in order to add credit to the machine there must be funds available in your postage account. For more specific information on your franking machine, please visit [www.myquadient.co.uk](http://www.myquadient.co.uk) and log in to your account.



A0139553/B - 30/03/2021

To access your full user guide, please visit : [kb.quadient.co.uk/ix5\\_ug](http://kb.quadient.co.uk/ix5_ug)